

8 7 6 5 4 3 2 1

H
G
F
E
D
C
B
A

H
G
F
E
D
C
B
A

This end towards telescope axis

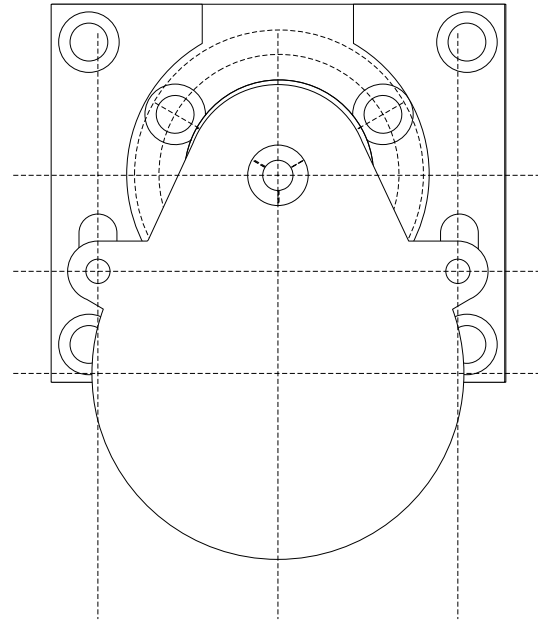

Top View, showing motor

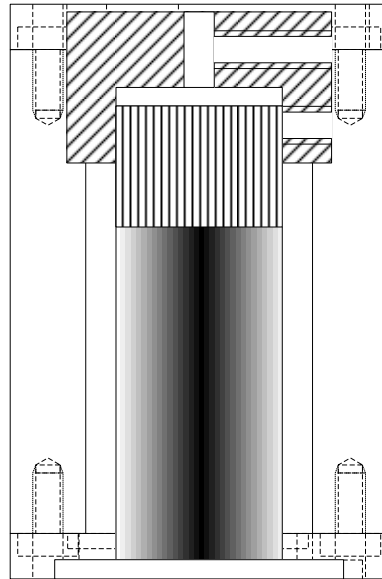

Side View without motor

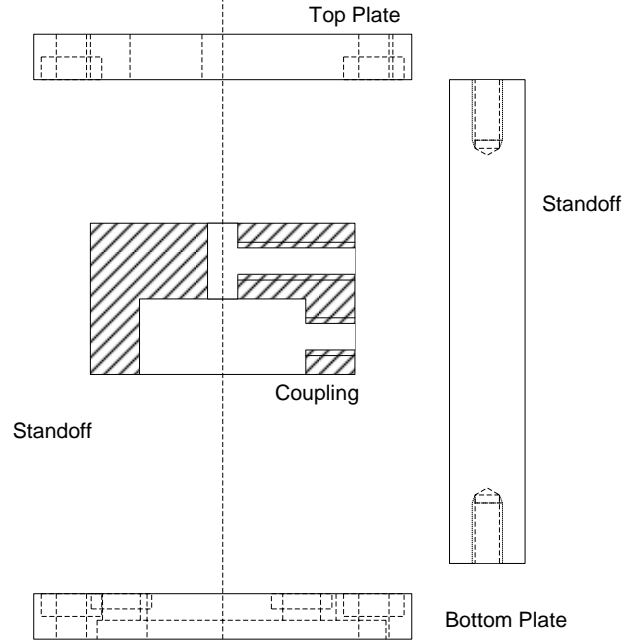

Exploded View

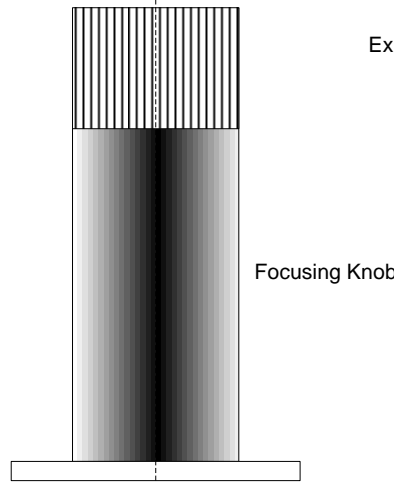

Focusing Knob

Assembly Instructions

1. Attach 4 stand offs to bottom plate with M4 x 12mm long brass machine head screws.
2. Remove fixing screws from Meade focusing, knob. Use these to mount bottom plate/standoff assembly to telescope (note that this action also re-mounts the focusing knob) – the recess in the bottom of the mounting plate is less deep than the plate that attaches the focusing assembly to the telescope.
3. Attach top plate to standoffs with M4 x 12mm long brass machine head screws.
4. Attach coupling to motor shaft using M5 grub screw.
5. Place coupling (with attached motor) over focussing knob, until motor rests on top plate.
6. Make sure that the motor is aligned with the slotted holes on the top plate and use the supplied screws to mount the motor on the top plate.
7. Use an M5 grub screw to clamp the coupling to the focusing knob.

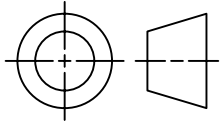

All dimensions in millimetres

Lakeside Astro Focus Motor Bracket for 12" LX200
Assembly

REVISIONS

REV	DESCRIPTION	DATE	APPROVED
A	Initial Design	23 rd Aug 2009	
B	Revised during manufacture	6 th Sep 2009	

A

A

SIZE	FSCM NO	DWG NO	REV
A4		0023	B
SCALE	1:1	SHEET	1 OF 5

8 7 6 5 4 3 2 1

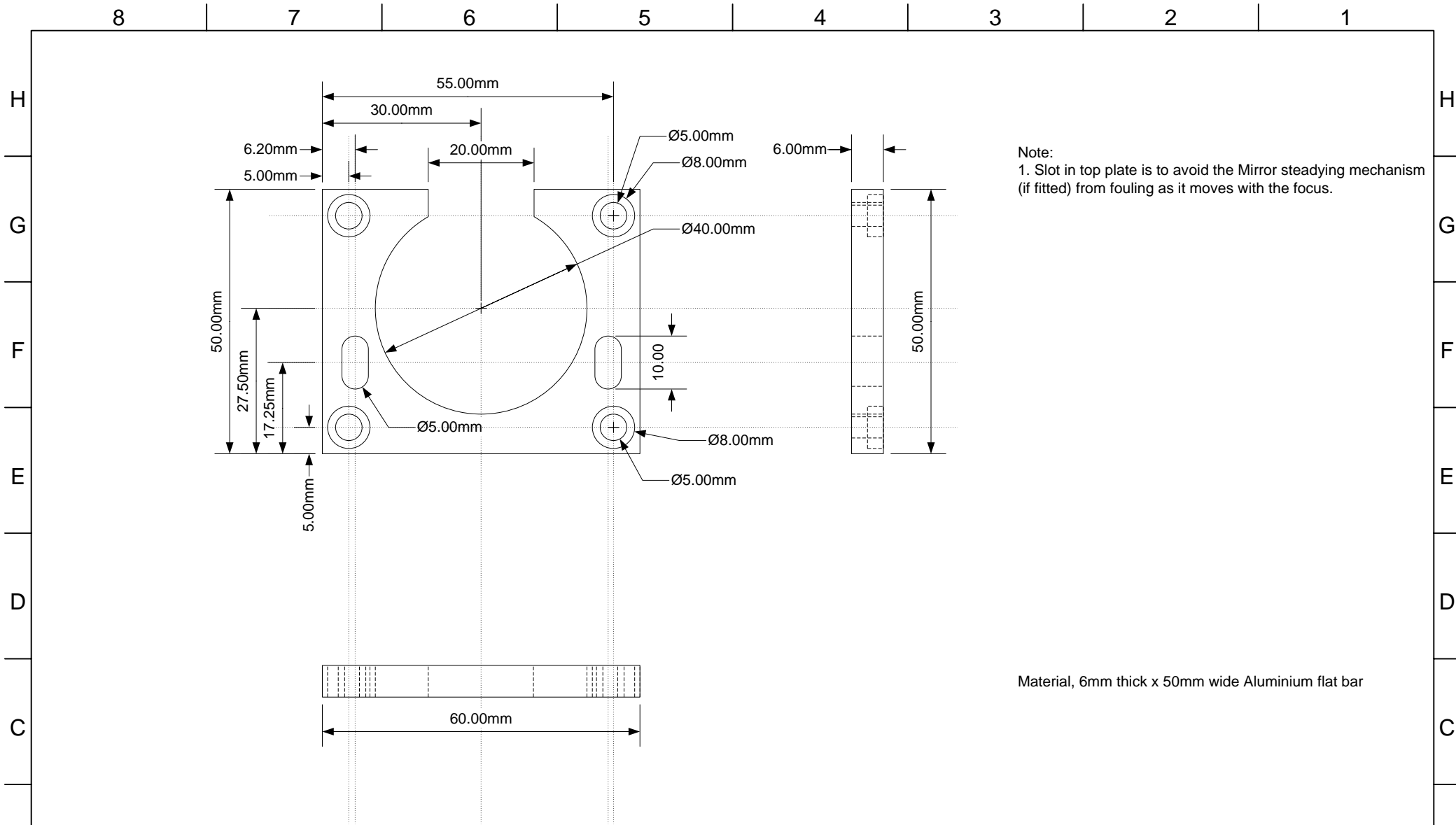

Note:
 1. Slot in top plate is to avoid the Mirror steadying mechanism (if fitted) from fouling as it moves with the focus.

Material, 6mm thick x 50mm wide Aluminium flat bar

	All dimensions in millimetres			REVISIONS			
	Lakeside Astro Focus Motor Bracket for 12" LX200 Top Plate			REV	DESCRIPTION	DATE	APPROVED
			A	Initial Design	23 rd Aug 2009		
			B	Revised during manufacture	6 th Sep 2009		
SIZE	FSCM NO	DWG NO	REV				
A4		0023	B				
SCALE	1:1	SHEET	2 OF 5				

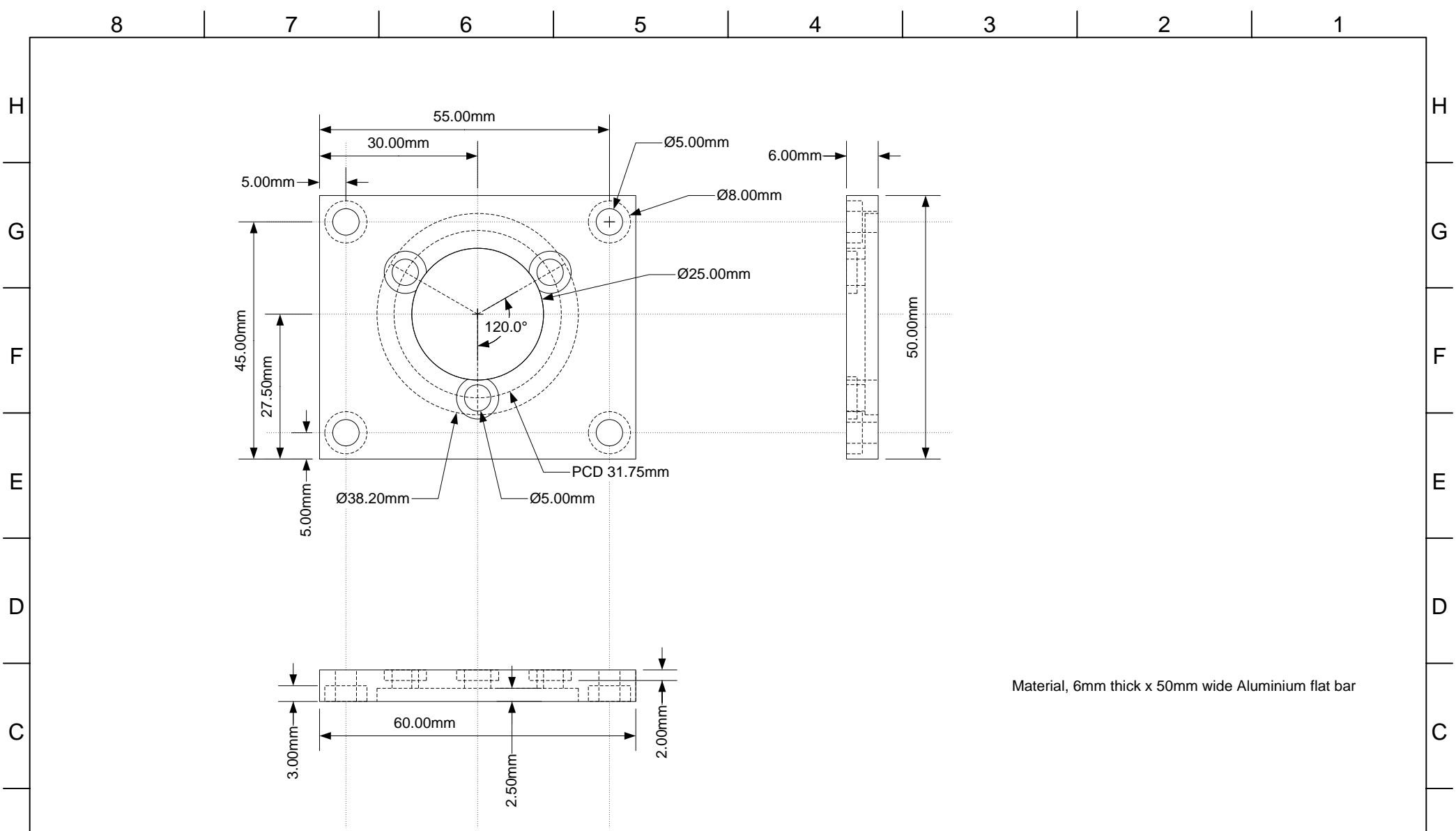

Material, 6mm thick x 50mm wide Aluminium flat bar

	All dimensions in millimetres			REVISIONS			
	Lakeside Astro Focus Motor Bracket for 12" LX200 Base Plate			REV	DESCRIPTION	DATE	APPROVED
			A	Initial Design	23 rd Aug 2009		
			B	Revised during manufacture	6 th Sep 2009		
SIZE	FSCM NO	DWG NO	REV				
A4		0023	B				
SCALE	1:1	SHEET	3 OF 5				

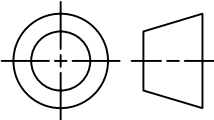
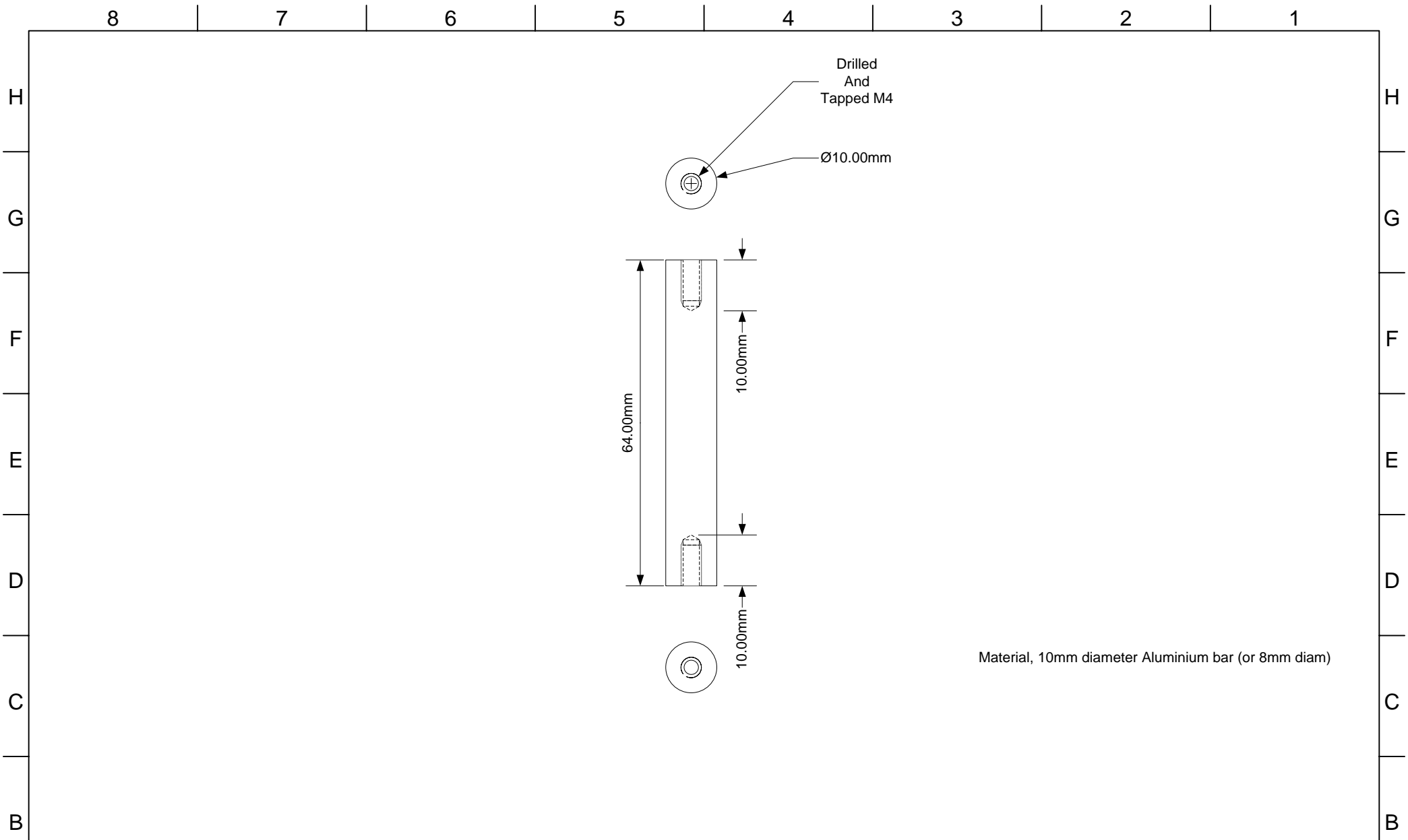

All dimensions in millimetres

Lakeside Astro Focus Motor Bracket for 12" LX200 Stand-Off

REVISIONS			
REV	DESCRIPTION	DATE	APPROVED
A	Initial Design	23 rd Aug 2009	
B	Revised during manufacture	6 th Sep 2009	

SIZE A4	FSCM NO	DWG NO 0023	REV B
SCALE 1:1	SHEET 4 OF 5		

A

A

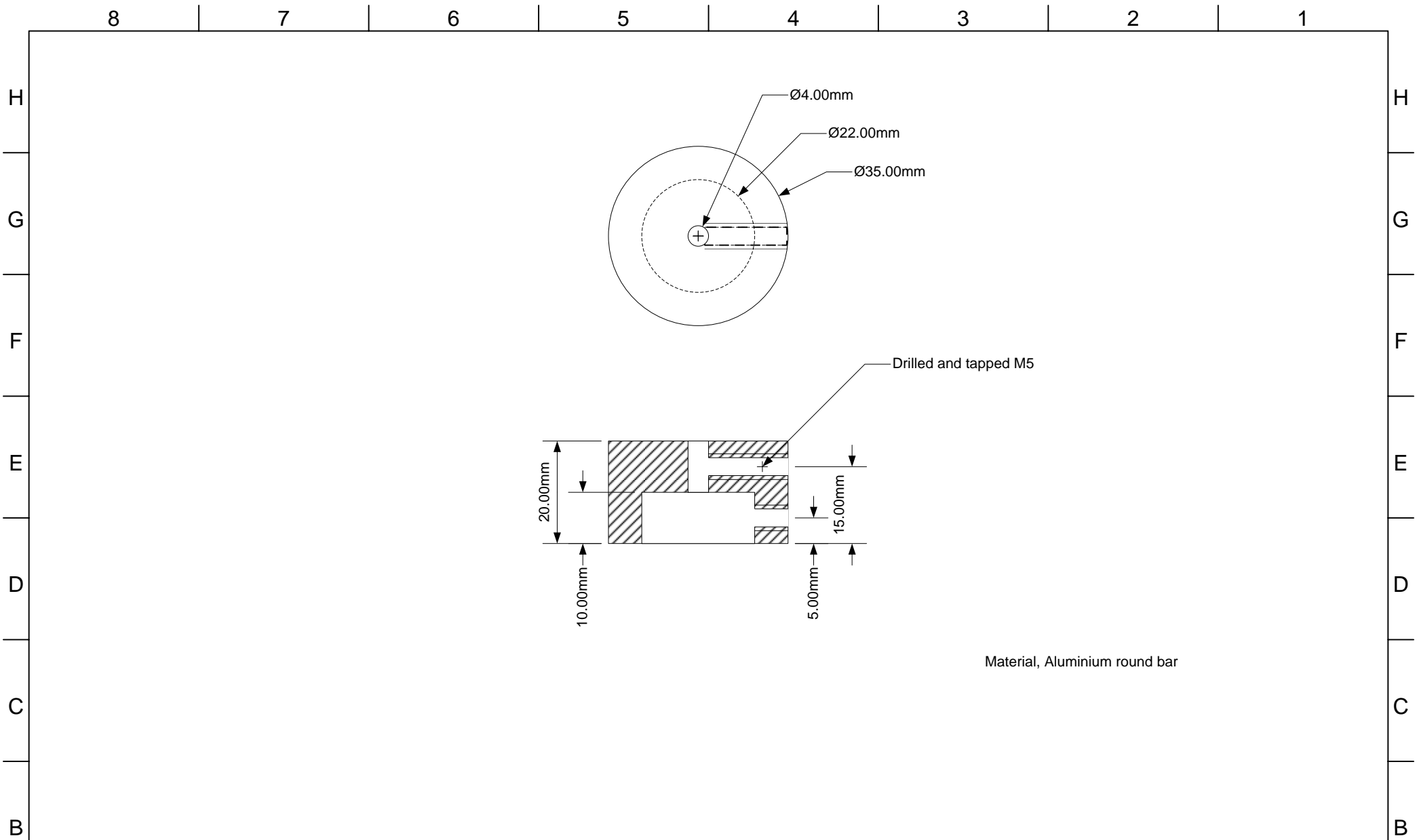

Material, Aluminium round bar

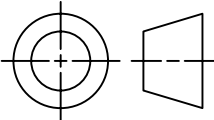

All dimensions in millimetres
 Lakeside Astro Focus Motor Bracket for 12" LX200
 Coupling

				REVISIONS			
REV	DESCRIPTION	DATE	APPROVED				
A	Initial Design	5 th Sep 2009					

SIZE	FSCM NO	DWG NO	REV
A4		0023	A
SCALE	1:1	SHEET	5 OF 5

A

A